

## RUBBER COATING MAGNETS/PLASTIC

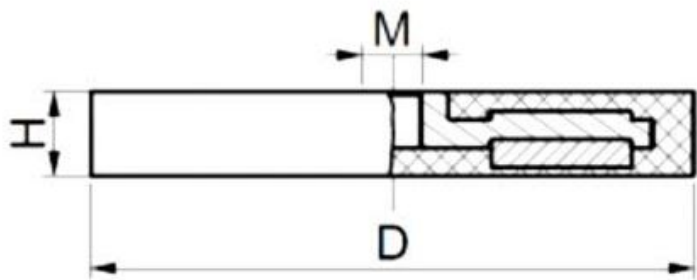

MAGNETIC SYSTEM MADE ON RUBBER can be used in warm condition.  
The coating, made on rubber, guarantees a secure grip, and ensures excellent adhesion to the surface.

### BLIND THREADED HOLE



CODE	D	H	HOLE (M)	HEIGHT HOLE	STRENGTH
SM35.35GO00.308M4GO M	30	8	M4	7	8
SM35.35GO00.348M4GO M	34	8	M4	4	8,2
SM35.35GO00.436M4GO M	43	6	M4	6	8,5
SM35.35GO00.668M6GO M	66	8,5	M6	7	2
SM35.35GO00.8888GOM MA	88	8	M8	6	4

### CYLINDRICAL HOLE



CODE	D	H	HEIGHT HOLE	STRENGTH KG
SM37.35GO00.30066	31	6	D6	6
SM37.35PL00.3496 PLASTICA	34	9	D6	11

**COUNTERSUNK HOLE**



CODE	D	H	HEIGHT HOLE	STRENGTH KG
------	---	---	-------------	-------------

SM56.35GOSV.2264.5	22	6	4,5	4,50
SM56.35GOSV.3484.5	34	8	4,5	7,80
SM56.35GOSV.4364.5	43	6	4,5	11,40

### THREADED ROD

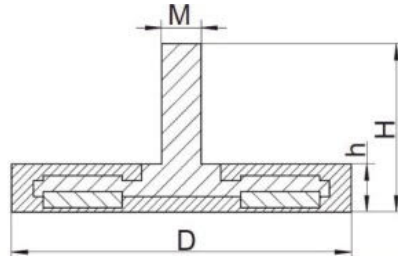

CODE	D	H	THREAD TYPE	STRENGTH KG
SM57.35GO00.226M4	22	6	M4X6,5	5
SM57.35GO00.436M6	43	6	M6X15	8
SM57.35GO00.668M8	66	8	M8X15	20
SM57.35GO00.888.5M8	88	8,5	M8X16	42

Max temperature 80 °C [Physical Magnet Data Sheet](#)

**All measurements are in millimeters. Other sizes and shapes on request.**